

BEACON ENGINEERING COMPANY ROTHSAY, MINNESOTA 56579

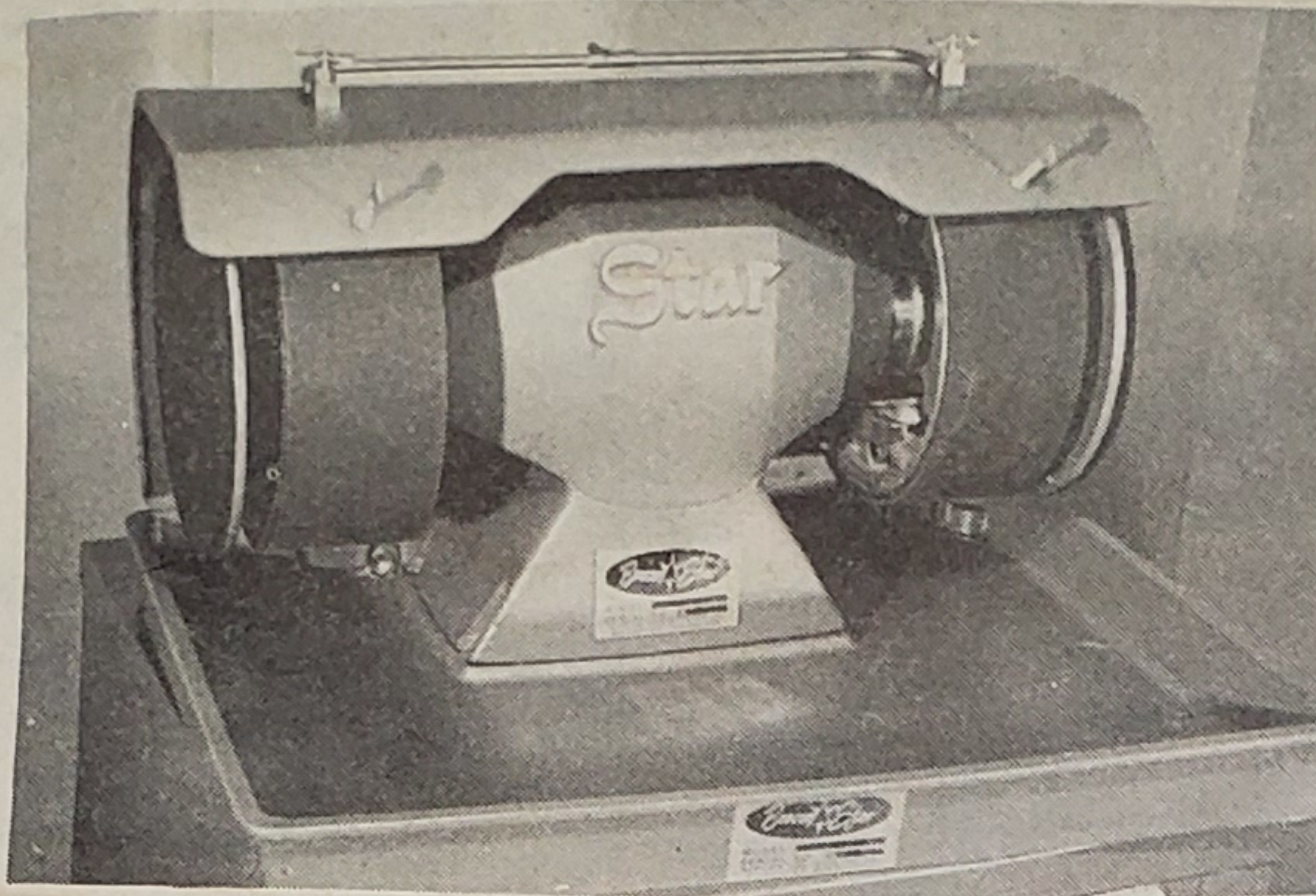

INSTALLATION AND HOOK UP

1. Carefully unpack and check for shipping damage. If damage exists, contact your shipping agent.

2. Mount unit on a sturdy bench or table. Bolt down through four holes in corners of base. Mount motor either behind or below unit. NOTE: Motor pulley should be a 2"-3"-4" diameter installed opposite to arbor pulley. This pulley available from Beacon Engineering if required. State size of shaft. Adjust belt fairly tight to prevent slippage and power loss. Avoid over-tightening, as this will decrease bearing life.

3. Connect water supply, either city water or a recirculation system can be used. Remove drain plug at bottom rear of base pan and attach drain system to suit your requirements.

4. Install grinding wheels, sanding drums, polishing discs and buffs to your requirements. Beacon Line accessories are recommended to insure proper sizes and fit. These accessories may be mounted one of the following three ways.

a. For sanding drums, smooth bore is recommended-securing them by wheel flanges. Threaded bore drums are available if required. Threaded bores are recommended for sanding and polishing discs as they thread on the end of the shaft and may be used on the outside of a sanding drum or grinding wheel.

b. Grinding wheels and felt buffs should be mounted using flanges on both sides of the wheel and tightening with the nuts provided or a threaded polishing disc. NOTE: Nut on left side of arbor uses left hand thread.

c. If set screws are used with drums and discs a brass insert should be used under set screw to prevent scoring shaft or threads. Avoid the use of set screws, however, when possible.

5. Rotate Ad-A-Unit arbor by hand to insure that everything is running freely. Adjust wheel wipers down so that they just touch wheels or drums, now try it. Additional felts are included and may be cemented on with any waterproof cement.

LUBRICATION: The Ad-A-Unit shaft operates on permanently lubricated and sealed ball bearings. No periodical lubrication is required. Follow the manufacturers recommendations for lubrication of your lubrication of your electric motor.

MOTOR: The Beacon Star Ad-A-Unit requires a $\frac{1}{4}$ to $\frac{1}{3}$ H. P. 1750 R.P.M. motor. These motors are readily available locally or may be purchased from Beacon Engineering Company.

Beacon Star arbors have the exclusive feature of the split-top design. The arbor may be easily disassembled by removing four bolts. The shaft can then be lifted out for the easy exchange or replacement of the belt. Plenty of clearance is allowed for use of expando wheels.

Ad-A-Unit Accessories available from Beacon Engineering:

1. For 8" Ad-A-Unit

- A. 8" "Quik-Change" Sanding Drums
- B. 8" Grinding Wheels - 100 & 220 Grit
- C. 8" Flat Discs, Right & Left Hand Thread
- D. 8" Convex Discs, Right & Left Hand Thread
- E. 8" dia Elkhide Polishing Leathers
- F. $\frac{1}{3}$ H.P. 110 V. Electric Motor
- G. 8" expando drums & belts.

2. For 6" Ad-A-Unit

- A. 6" Expando-Drums & Replacement Endless Sanding Belts
- B. 6" Grinding Wheels - 100 & 220 Grit
- C. 6" Flat Discs, Right & Left Hand Thread
- D. 6" Norton Rubber Bonded Sanding Wheels
- E. 6" Elkhide Polishing Leathers
- F. $\frac{1}{4}$ H.P. 110 V. Electric Motor

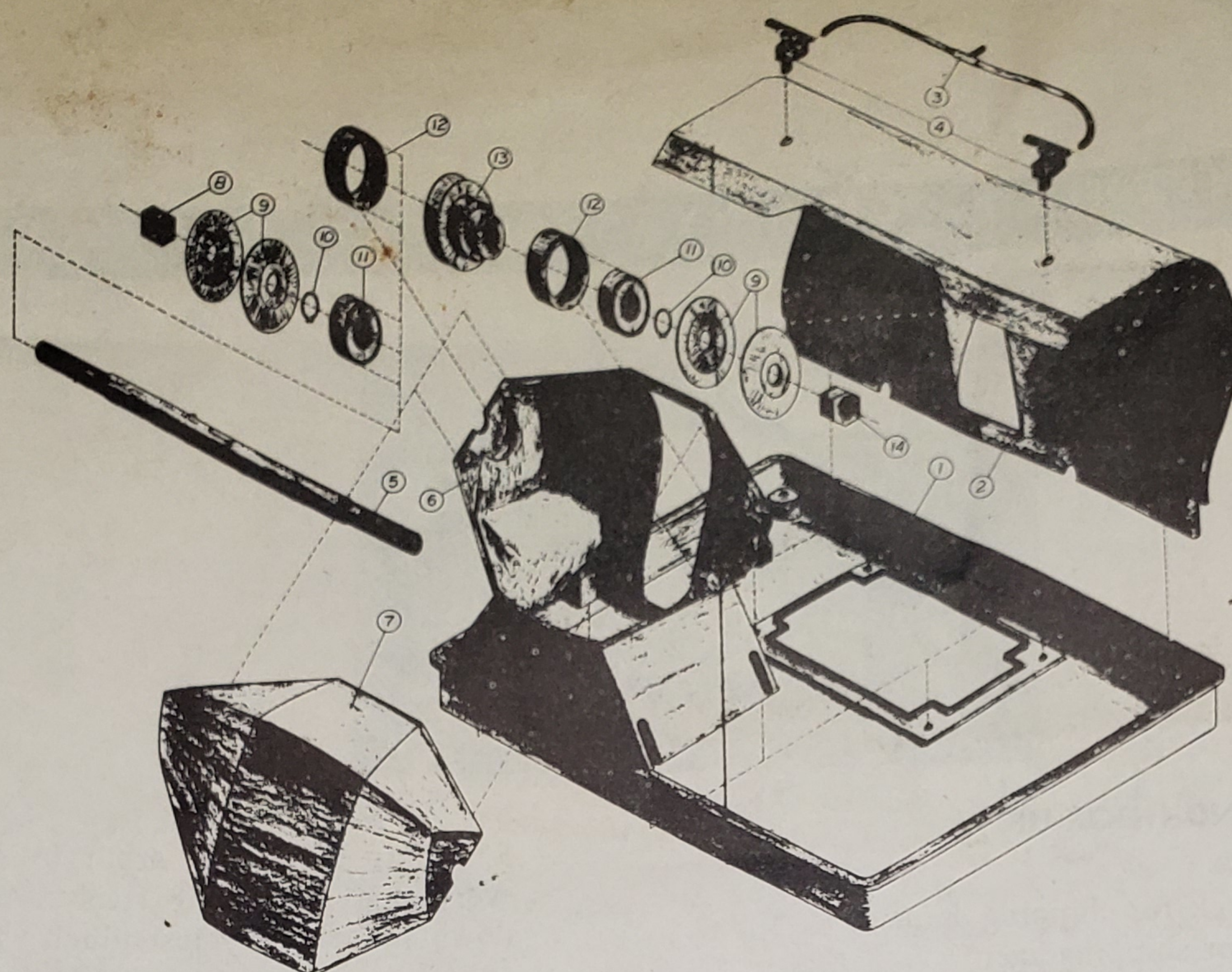

PARTS LIST - 6" AD-A-UNIT

<u>Ref. No.</u>	<u>Part No.</u>	<u>Nomenclature</u>	<u>List Price</u>
1	L3025	Pan Casting	10.95
2	L3026	Hood Casting	12.95
3	L3027	Coolant Manifold Assembly	4.94
4	A555	Coolant Valves (2 ea.) ea.	1.50
5	L3007	Shaft	6.50
6	L3001	Arbor Base Casting	6.75
7	L3002	Arbor Cap Casting	3.90
8	L3008	Nut - "Left-hand" Thread	.30
9	L3006	Wheel Flange (4 ea.) ea.	.75
10	L3010	Retaining Ring (4 ea.) ea.	.15
11	L3004	Sealed Ball Bearings (2 ea.)	2.40
12	L3003	Neoprene Bearing Mounts (2 ea.) ea.	.60
13	L3005	3-Step Pulleys	2.50
14	L3009	Nut - "Right-hand" Thread	.30
Not Shown	L3028	Stainless Wipers (2) ea.	.95
Not Shown	None	Wiper Felts (2 ea.) ea.	.05
Not Shown	L3011	V-Belt	1.50
	L3012	Tool bar rest ea. pr.	4.00

PARTS LIST - 8" AD-A-UNIT

<u>Ref. No.</u>	<u>Part No.</u>	<u>Nomenclature</u>	<u>List Price</u>
1	B5025	Pan Casting	15.95
2	B5026	Hood Casting	17.95
3	B5027	Coolant Manifold Assembly	4.95
4	A555	Coolant Valves (2 ea.) ea.	1.50
5	B5007	Shaft	7.50
6	B5001	Arbor Base Casting	10.00
7	B5002	Arbor Cap Casting	7.00
8	B5008	Nut - "Left-hand" Thread	.35
9	B5006	Wheel Flanges (4 ea.) ea.	4.50
10	B5010	Retaining Ring (2 ea.) ea.	.15
11	B5004	Sealed Ball Bearings (2) ea.	3.25
12	B5003	Neoprene Bearing Mounts (2) ea.	.70
13	B5005	3-Step Pulleys	2.50
14	B5009	Nut - "Right-hand" Thread	.35
Not Shown	B5028	Stainless Wipers (2 ea.) ea.	.95
Not Shown	None	Wiper Felts (2 ea.)	.05
Not Shown	B5011	V-Belt	1.50
	B5012	Tool bar rests ea. pr.	4.50

HOW TO ORDER REPAIR PARTS

When ordering repair parts please provide following information: Model Number; Part Number, Name and Price as shown in the parts list. All prices subject to change without notice, F. O. B. Rothsay. Minimum billing \$1.00. Address order and make remittance payable to-

BEACON ENGINEERING COMPANY

Rothsay, Minnesota 56579